

Orona 3G X-28

Machine-room above electrical gearless solutions

With the latest direct drive technology in public buildings.
Less noise and more accessible maintenance. The large-scale customised solution with a machine room, with maximum performance and maintenance efficiency.

General specifications

Load	1,650 to 2,500 kg
Capacity	22 to 33 persons
Speed	0.6 - 1 - 1.6 m/s
Maximum travel	50 - 50 - 75 m
Maximum floors served	32 floors
Entrances	1 front / 2 open through
Drive system	Direct gearless
Controller	ARCA II controller, low energy microprocessor
Door types	Automatic side-opening / Automatic central-opening
Clear door opening	From 900 to 2,500 mm (in increments of 100 mm)
Door height	2,000 / 2,100 / 2,200 / 2,300
Car dimensions	Parametric car dimensions
Internal car height	2,100 / 2,200 / 2,300 / 2,400
Aesthetic solutions	Orona 3G Plus

Standard Optional

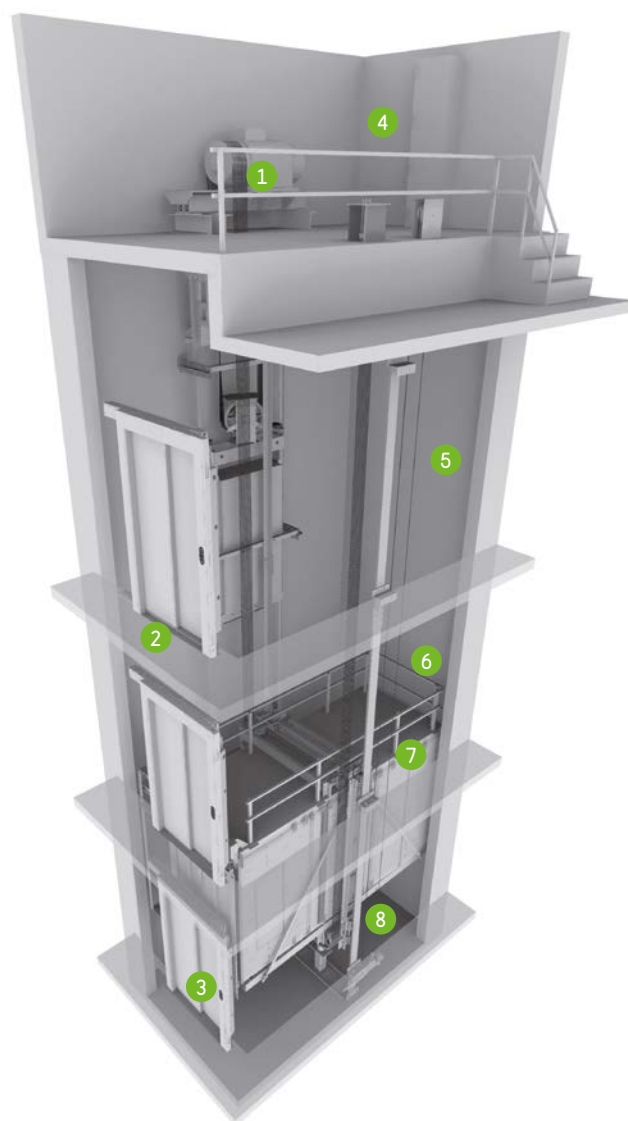

1 DRIVE

Compact, quiet, gearless, energy efficient, speed regulated (VVVF) permanent magnet electric motor.



2 AUTOMATIC RESCUE SYSTEM

With floor level indication to ensure fast, efficient and safe evacuation of passengers in the event of an emergency. As an option, the system can incorporate a fully-automatic rescue device to evacuate passengers in the event of a power failure.



3 SOLID DOORS

Extra robust doors with reduced sound levels inside and outside the lift and which are specially constructed for high volume passenger traffic.



4 MACHINE-ROOM

A traditional solution simplifying lift maintenance.



5 PARAMETRIC/FLEXIBLE

Flexible car and door configurations ensure available shaft dimensions can be optimised (optional).



6 ROBUST LIFT CAR

Provides greater comfort during lift travel, with reduced vibration and noise.



7 CARS

Reinforced wall panels and flooring provides durability for heavy duty usage. Flexible configurations offering optimum car and door dimensions.







8 ACCESSIBLE SPACE BELOW THE PIT

Adapts the lift to suit buildings which have an accessible space below the pit (optional).



Standard dimensions

Load / capacity				Car				Lift shaft *				
Speed		 Persons	Q Load	AC Width	FC Depth	PL Clear opening	Type	No. of entrances	AH ¹ Width	FH Depth	HF ² Pit	HUP ³ Last Floor
0.6 m/s		24	1,800 kg	2,350	1,600	1,200	CC	1 2 x 180 ⁰	3,150	1,950 2,160	1,450	3,400
				2,350	1,700	1,200	CC	1 2 x 180 ⁰		2,050 2,260		
		1,500	2,700					1,300	TT	1 2 x 180 ⁰		
				1,800	2,700	1,300	TT			1 2 x 180 ⁰		
		26	2,000 kg					2,350	1,700	1,200		
				1,500	2,700	1,300	TT	1 2 x 180 ⁰	3,050 3,260			
1 m/s		24	1,800 kg	2,350	1,600	1,200	CC	1 2 x 180 ⁰	3,150	1,950 2,160	1,450	3,425
				2,350	1,700	1,200	CC	1 2 x 180 ⁰		2,050 2,260		
		1,500	2,700					1,300	TT	1 2 x 180 ⁰		
				1,800	2,700	1,300	TT			1 2 x 180 ⁰		
		26	2,000 kg					2,350	1,700	1,200		
				1,500	2,700	1,300	TT	1 2 x 180 ⁰	3,050 3,260			
1.6 m/s		24	1,800 kg	2,350	1,600	1,200	CC	1 2 x 180 ⁰	3,150	2,050 2,260	1,600	3,565
				2,350	1,700	1,200	CC	1 2 x 180 ⁰		2,050 2,260		
		1,500	2,700					1,300	TT	1 2 x 180 ⁰		
				1,800	2,700	1,300	TT			1 2 x 180 ⁰		
		26	2,000 kg					2,350	1,700	1,200		
				1,500	2,700	1,300	TT	1 2 x 180 ⁰	3,050 3,260			

- 1 With 2 panel telescopic doors
- 2 With PVC flooring. Marble floor option + 20 mm
- 3 HUP minimum for internal car height (HC) 2,100 mm.

CC - Two panel central door
TT - Two panel telescopic door

* Minimum plumb measurements

Layout

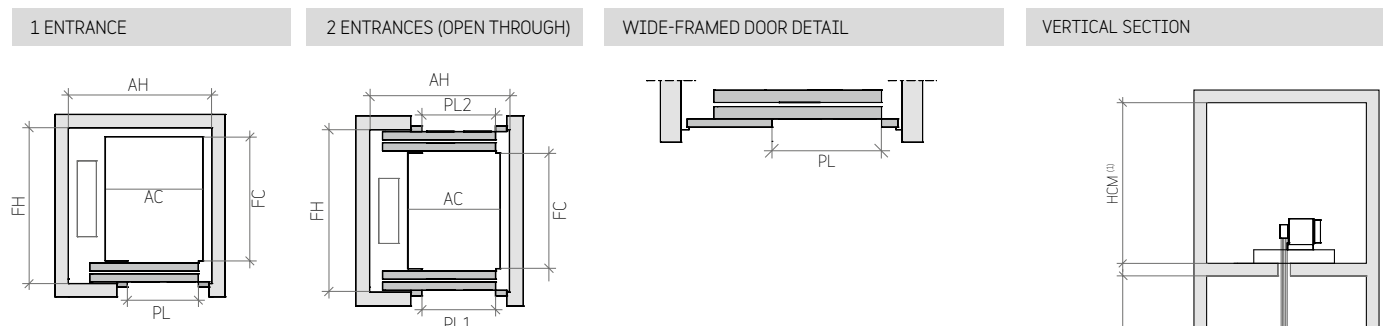

Customised car dimensions

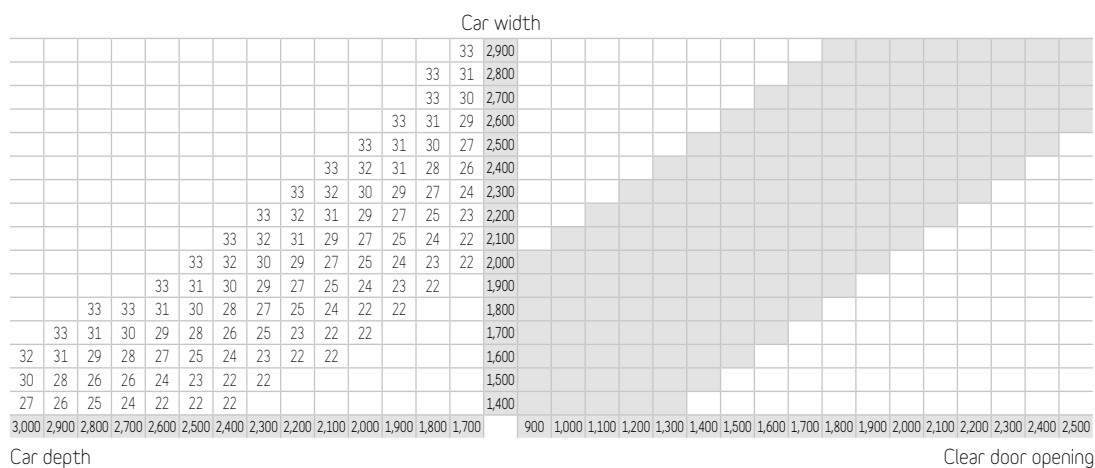

Note: Car width and depth variable in increments of 5 mm.

For simplification, table samples show increments of 100 mm.

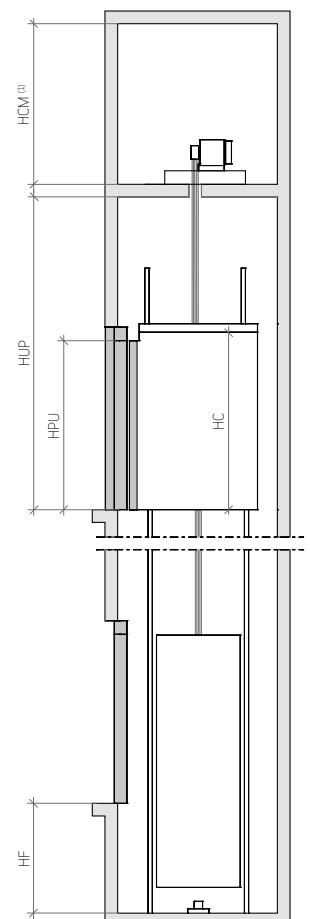

(1) HCM - minimum 2000 mm